

Centurion Interiors
Partition Systems

Demountable Partitions
Glass Partitions
Acoustic Glass Doors
Timber Doors
Bespoke Solutions



Installation Guide

System 9000: 30/0 FR - DG



Tape Measure



Toolbox



Drill



Mitre Saw



Laser Level

TRACK NOTES

Fixings for screwing to third party substrates are not provided by Truline Systems and should be assessed and sourced by the installation team.

It is common practice to install track as per the below:

Head track to abut adjoining walls.

Wall abutment between underside of head track and floor.

Base track to abut wall abutments.

If door frames are part of your build, review frame notes on page 3 for setting out.

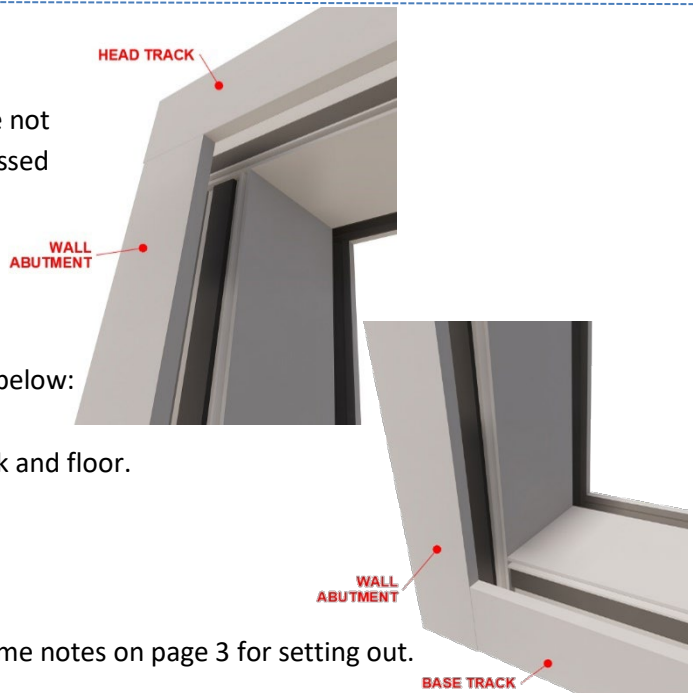

Accurately mark out the partitioning layout as per the layout drawings.

Cut the head channel to the required lengths and drill clearance holes through the glazing pockets for suitable structural fixings.

Before securing track, ensure a bead of fire mastic is applied to the back face of the track

Utilising the straight (S9SCLEAT), splice track lengths together.

Once track is securely fixed, proceed by push fitting the S9UGASK into the bead (non-fire side only) and non-fire glazing pocket chair.

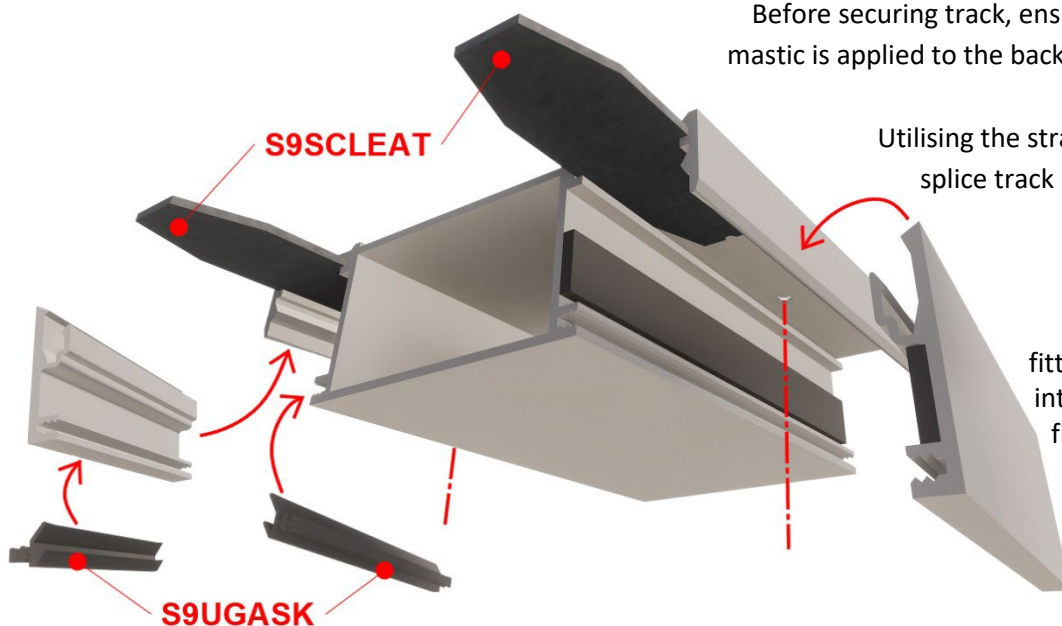

Both beads can now be clipped into glazing chair.

TRACK - STEP 1

TRACK - STEP 2

Cut the wall abutment channels to the required lengths and drill clearance holes through the glazing pockets for suitable structural fixings.

Before securing track, ensure a bead of fire mastic is applied to the back of the track.

Once track is securely fixed, proceed by push fitting the S9UGASK into the bead (non-fire side only) and non-fire glazing.

Both beads can now be clipped into glazing chair.

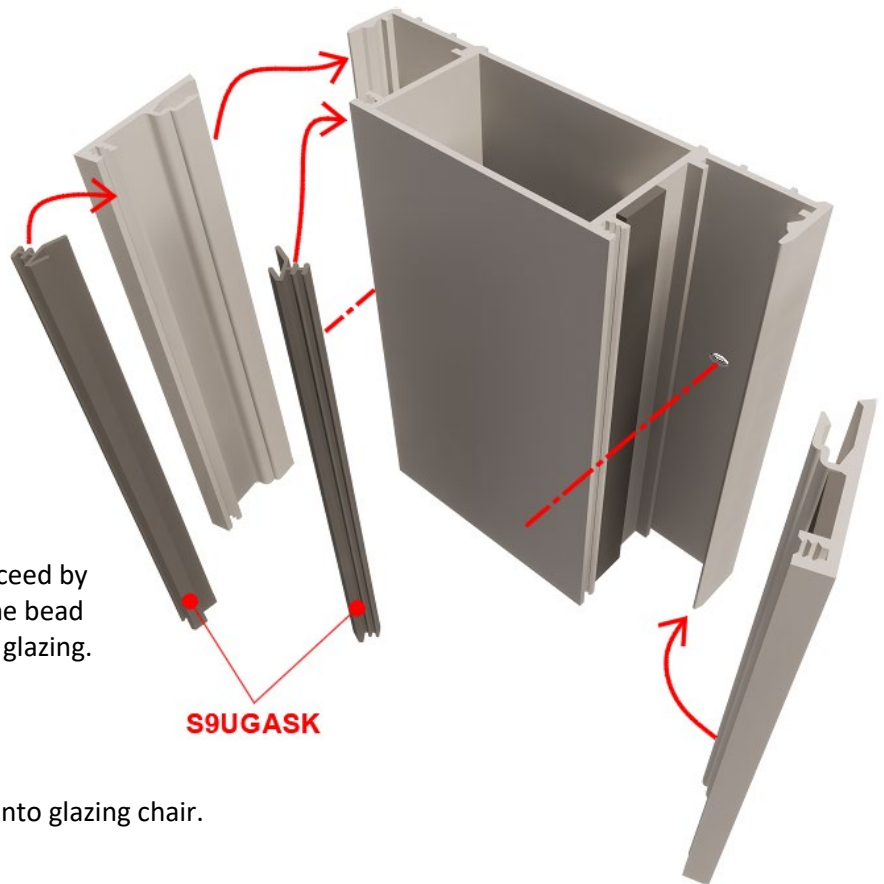

Cut the base channel to the required lengths and drill clearance holes through the glazing pockets for suitable structural fixings.

Before securing track, ensure a bead of fire mastic is applied to the back of the track.

Utilising the straight cleat (S9SCLEAT), splice track lengths together.

Once track is securely fixed, proceed by push fitting the S9UGASK into the bead (non-fire side only) and non-fire glazing pocket chair.

Both beads can now be clipped into glazing chair.

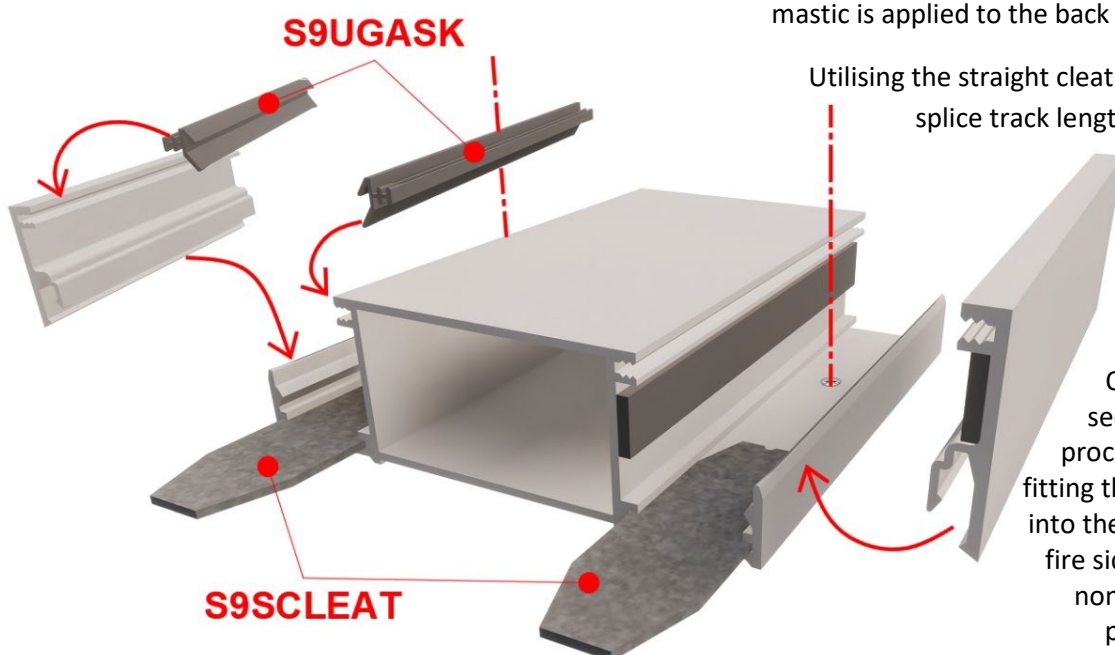

TRACK - STEP 3

TRACK - STEP 4

When glass is ready to be installed, carefully utilise a lift, drop and shuffle technique to glaze the system, whilst ensuring all glass kite marks are visible and shown in the bottom right-hand corner.

Gap between glass panes = 4mm

Once glass is in place, the removable beads can be secured back into place.

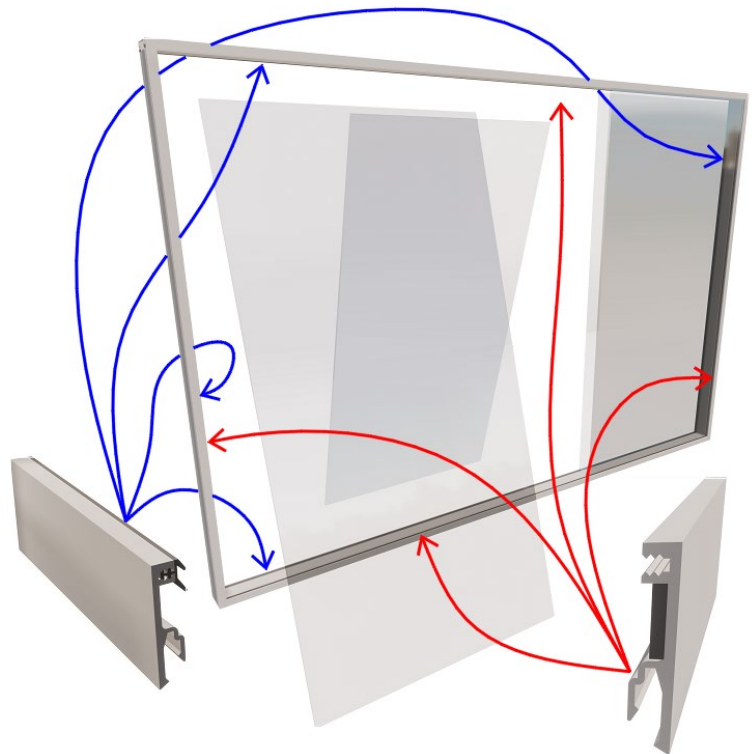

Utilising the relevant setting out drawing, cut the glazing track to suit door frame type.



**Full height door frame
interrupting head track.**



System 9000 DG
Frame Setting Out

FRAME NOTES

FRAME - STEP 1

Note: All door frames are manufactured to be at least 50mm oversized for onsite trimming.

Unpack the door frame and all loose components.

Assemble the frame by installing the (x4) mitre cleats (x2 per mitre).

Using the (x2) 4.2 x 38mm pan head screws provided, fix down through the door frame head into the screw ports located in the mitred stiles.

Secure floor plate to floor and (when offering the frame into place) slide on top of the plates.

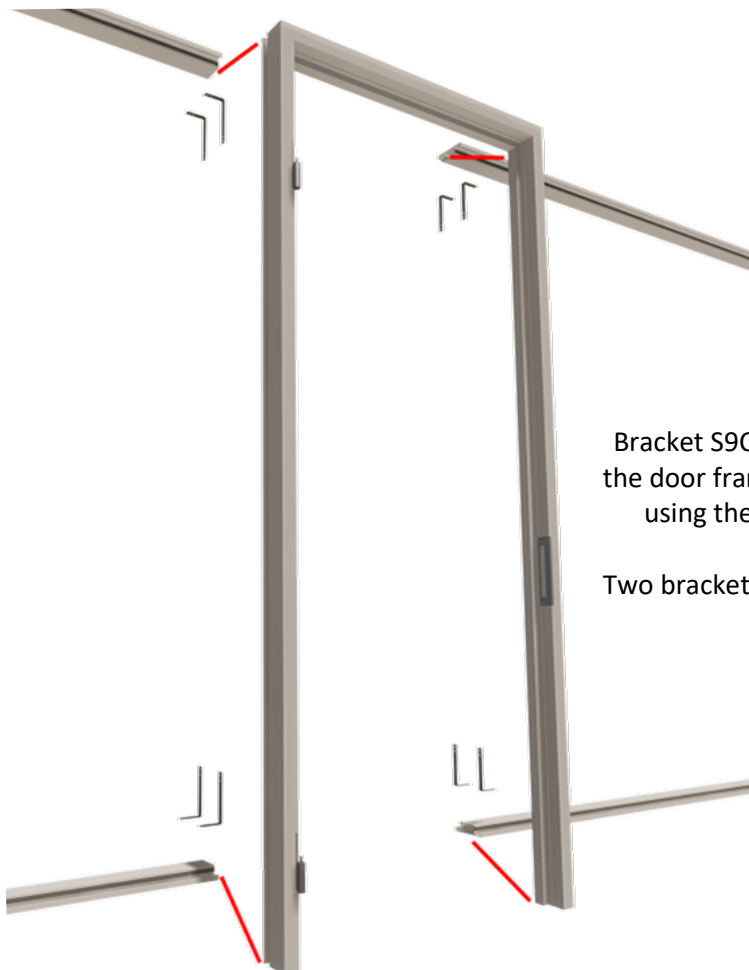
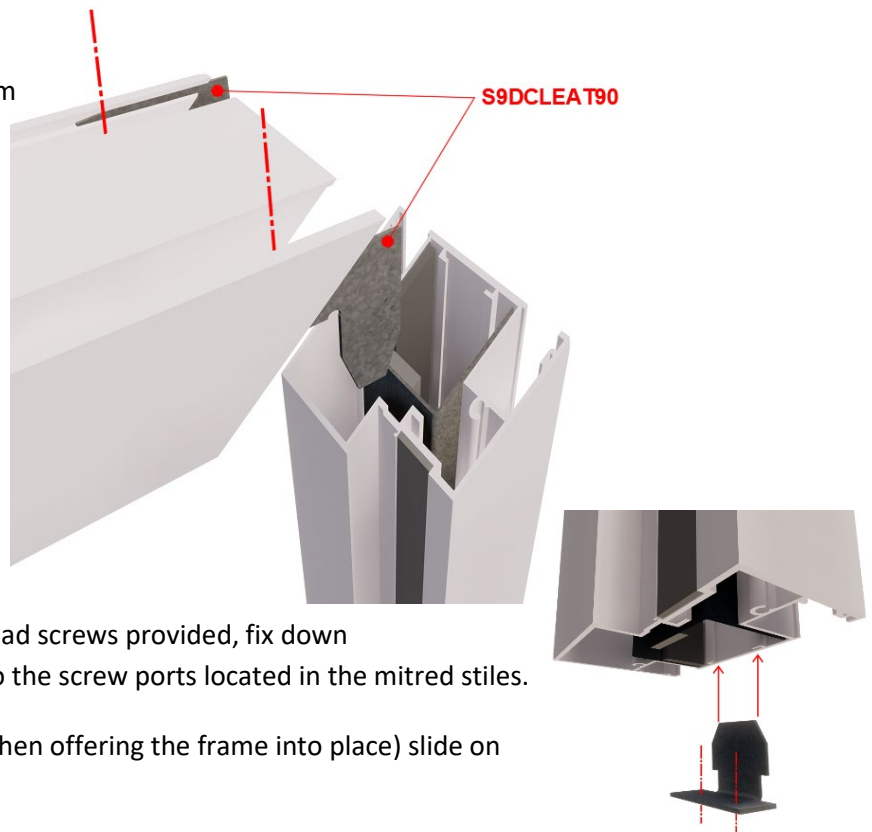

Bracket S9CB is positioned within the glazing reveal of the door frame and head track. Fix into the door frame using the countersunk self-drilling screws provided.

Two brackets are required for each door frame pocket.

FRAME - STEP 2

FRAME - STEP 3

Now that the door frame has been securely fixed into place, push fit the PTDS door seal into the groove on both door frame stiles and head and the S9UGASK into the non-fire side door frame pockets.

S9UGASK to be fitted into the non-fire door frame pockets.

The intumescent strips can now also be installed into the rebate on both stiles and head.

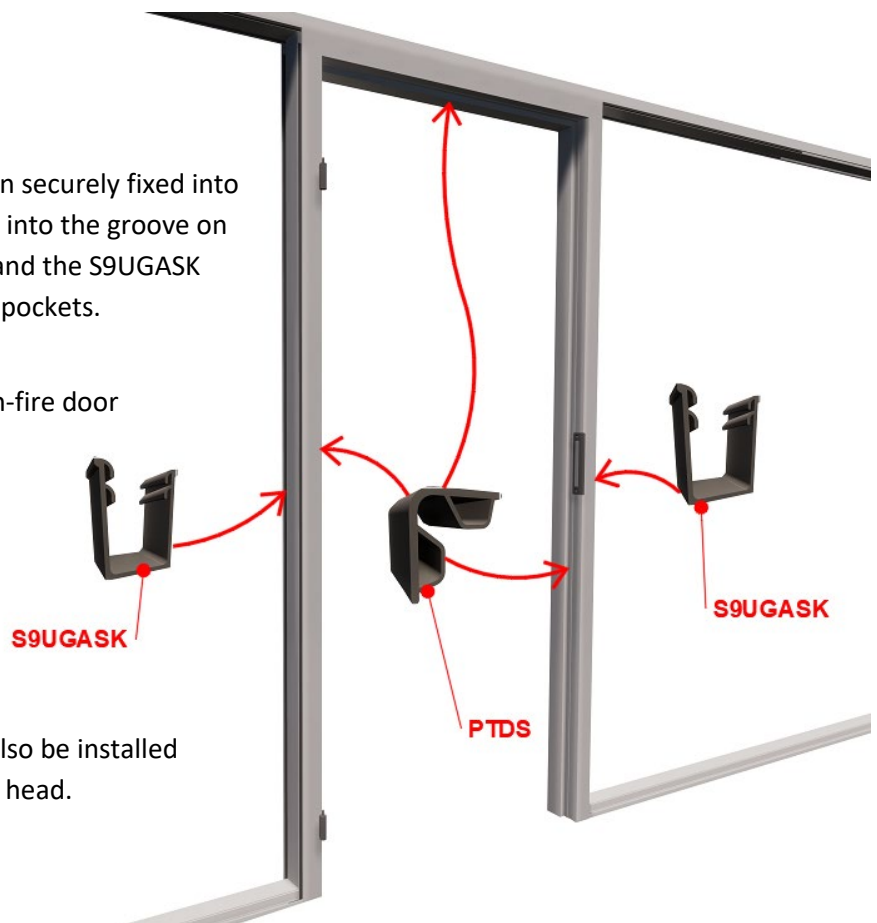

When glass is ready to be installed, carefully utilise a lift, drop and shuffle technique to glaze the system, whilst ensuring all glass kite marks are visible and shown in the bottom right-hand corner.

Gap between glass panes = 4mm

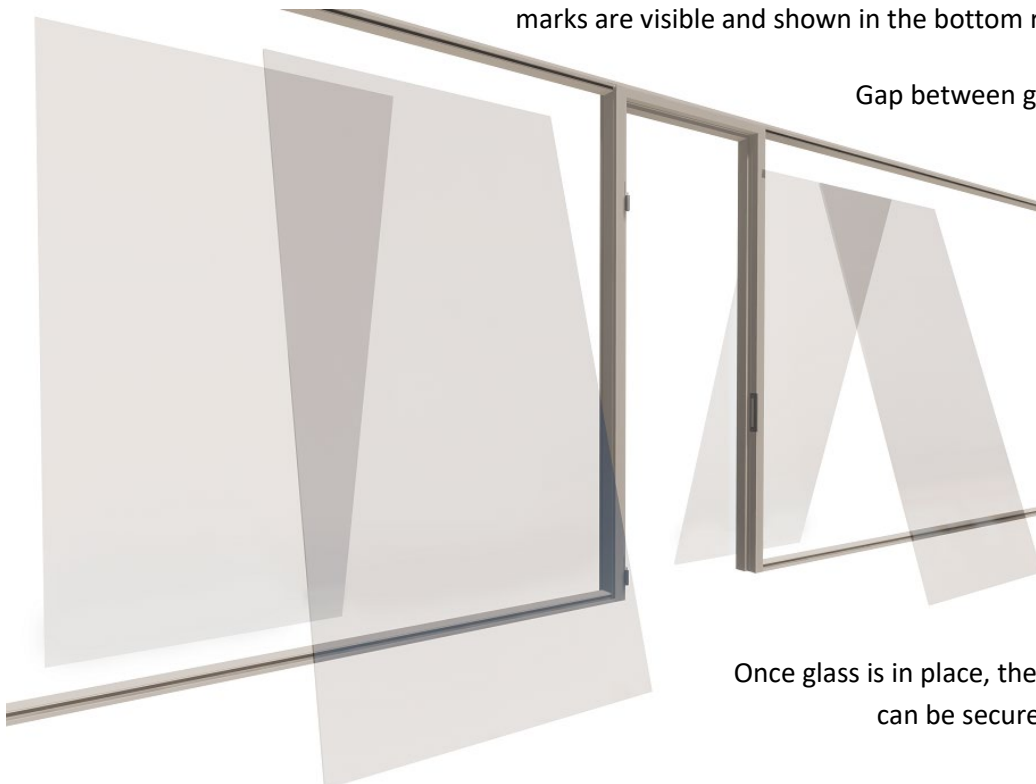

Once glass is in place, the removable beads can be secured back into place.

FRAME - STEP 4

Please scan the relevant QR code below for specific System 9000 documentation.



System 9000FR
Design Guide



Partitioning
Systems O&M



Doors O&M



Partitioning Safety
Data & COSHH



Doors Safety Data
& COSHH



If you have any questions regarding this installation guide or require further assistance, please contact Truline Systems technical team.

Contact Us:



Birmingham

NDI, Meridian Way
Core 42 Logistics Park
Watling Street
Tamworth
B78 1TX

T: 01213 522 460
E: birmingham@ndi.co.uk

London

NDI, Unit 18, IO Centre
Kimpton Park Way
Sutton
SM3 9BW

T: 020 8254 2380
E: london@ndi.co.uk

Maidstone

NDI, Loc8,
Unit 12
Maidstone
ME17 1XG

T: 01622 790 622
E: maidstone@ndi.co.uk

Milton Keynes

NDI, Unit 2, Bilton Road
Denby East
Bletchley
MK1 1HW

T: 01908 640 634
E: milton.keynes@ndi.co.uk

Newport

NDI, Unit 4
Tregwilym Road
Rogerstone
Newport
NP10 9DQ

T: 01633 898 340
E: newport@ndi.co.uk

Newton-Le-Willows

NDI, Unit 7
Anglezarke Road
Newton Le Willows
WA12 8DJ

T: 01925 220 827
E: newtonsales@ndi.co.uk

Poole

NDI, Albany House
Elliot Road
Poole
BH11 8JH

T: 01202 576 006
E: poole@ndi.co.uk

ndi.co.uk

Disclaimer

IT IS IMPORTANT THAT YOU READ AND UNDERSTAND THIS STATEMENT BEFORE MAKING USE OF THIS DOCUMENT.

This document is published by Truline Systems. The information contained within this publication is for general information purposes only. The publication has not been prepared to meet the individual requirements of any particular construction project and it is your responsibility to ensure that the construction materials, techniques and processes are suitable for that particular use.

The information contained within this publication is not intended to amount to, nor should it be relied upon as, formal advice or guidance (including from any qualified professional).

The information provided is only to be used and acted on by, or under the supervision of suitably qualified individuals and is correct at the time of going to press. However Truline Systems reserves the right to amend specifications without prior notification in accordance with our policy of continuous development.

The information in this publication is not to be used as a substitute for obtaining suitable independent, professional, qualified and/or specialist advice. If you are not a suitably qualified professional, you must obtain your own independent, specialist advice from a relevant qualified professional for any construction project.

Truline Systems shall not be liable for any loss of profit, revenue, business, contract, opportunity, goodwill, reputation, or any indirect, special or consequential loss arising out of, or in connection with, this publication.

If you have any queries, please contact technical@trulinesystems.co.uk