

Centurion Interiors  
**Partition Systems**

Demountable Partitions  
Glass Partitions  
Acoustic Glass Doors  
Timber Doors  
Bespoke Solutions



## Installation Guide

XP Door Frames



Tape Measure



Toolbox



Drill



Laser Level



Installation  
video guide

## Before you start.

Carefully unwrap frame.

Check frame fits structural opening and that the door handing is correct.

Remove loose fitted architrave and door stops.

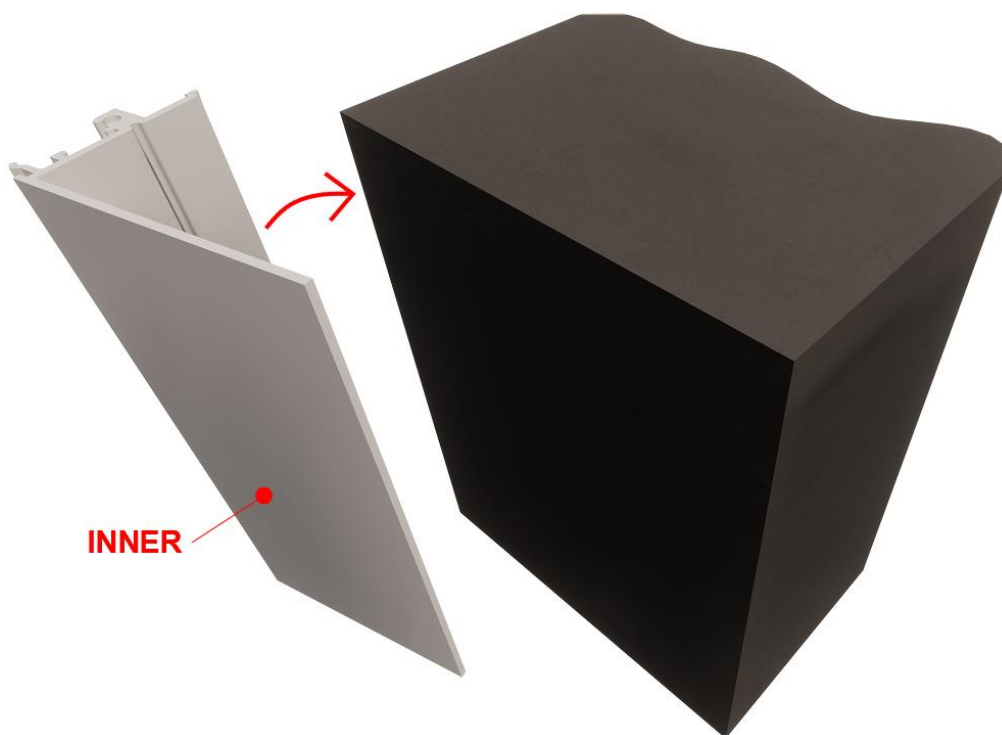

## STEP 1

Offer inner frame into opening and centralise. Level door frame head and clamp into position.

Fix head through pre-drilled holes on the architrave carrier to the structure, using suitable fixings.

Level and plumb legs, pack at fixing points, as necessary, and clamp.

Fix legs through the pre-drilled holes on the architrave carrier to the structure using suitable fixings.

## STEP 2

Offer outer frame into position, pull tight against inner frame and clamp.

Fix head through pre-drilled holes on the architrave carrier to the structure, using suitable fixings.

Within opening, pilot drill through the predrilled holes in the outer frame into the inner frame.

Fix through holes into the structure using suitable fixings, ensuring the fixings are not over tightened.

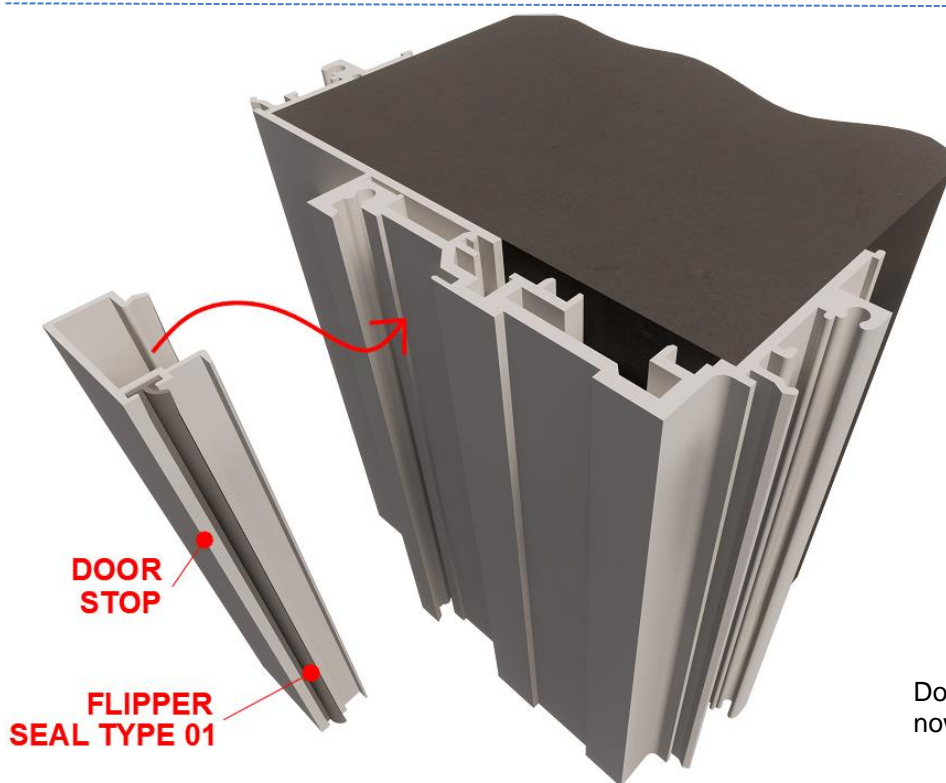
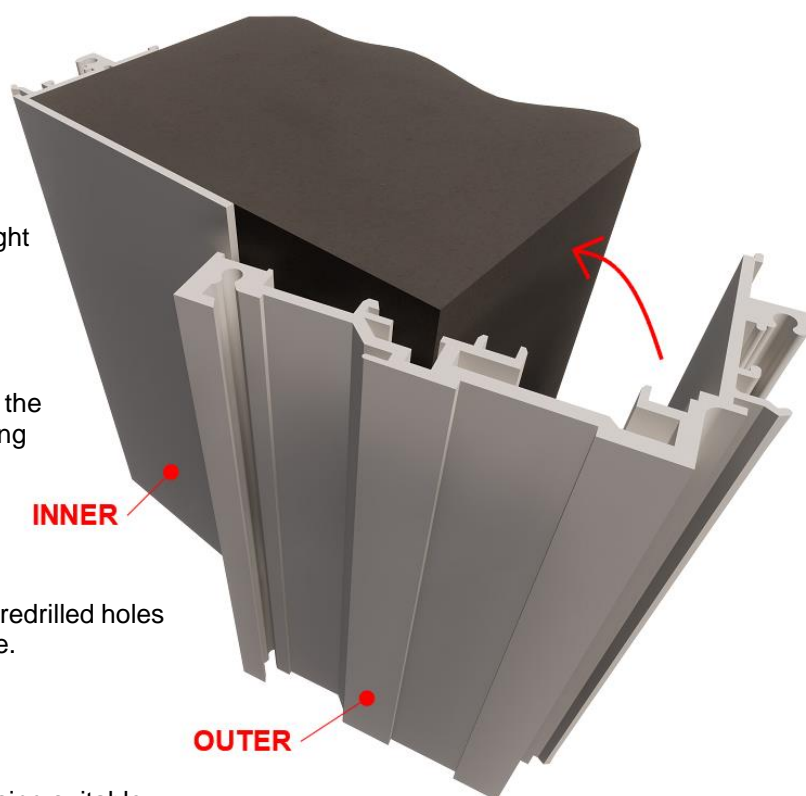

## STEP 3

Door frame flipper seal should now be slid into the door stops.

Starting with head, clip doorstops to outer frame.

STEP 4

Lift door into frame to ensure clearance required are correct.

Starting with head, clip architraves to inner and outer frames.



STEP 5



A thin flat filling knife or similar can be used to remove fitted architraves and doorstops.



XP Design  
Manual



XP Window Frame  
Installation Guide



Partitioning  
Systems O&M



Doors O&M



Partitioning Safety  
Data & COSHH



Doors Safety Data  
& COSHH



If you have any questions regarding this installation guide or require further assistance, please contact Truline Systems technical team.

## Contact Us:



### Birmingham

NDI, Meridian Way  
Core 42 Logistics Park  
Watling Street  
Tamworth  
B78 1TX

**T:** 01213 522 460  
**E:** birmingham@ndi.co.uk

### London

NDI, Unit 18, IO Centre  
Kimpton Park Way  
Sutton  
SM3 9BW

**T:** 020 8254 2380  
**E:** london@ndi.co.uk

### Maidstone

NDI, Loc8,  
Unit 12  
Maidstone  
ME17 1XG

**T:** 01622 790 622  
**E:** maidstone@ndi.co.uk

### Milton Keynes

NDI, Unit 2, Bilton Road  
Denby East  
Bletchley  
MK1 1HW

**T:** 01908 640 634  
**E:** milton.keynes@ndi.co.uk

### Newport

NDI, Unit 4  
Tregwilym Road  
Rogerstone  
Newport  
NP10 9DQ

**T:** 01633 898 340  
**E:** newport@ndi.co.uk

### Newton-Le-Willows

NDI, Unit 7  
Anglezarke Road  
Newton Le Willows  
WA12 8DJ

**T:** 01925 220 827  
**E:** newtonsales@ndi.co.uk

### Poole

NDI, Albany House  
Elliot Road  
Poole  
BH11 8JH

**T:** 01202 576 006  
**E:** poole@ndi.co.uk

### ndi.co.uk

#### Disclaimer

IT IS IMPORTANT THAT YOU READ AND UNDERSTAND THIS STATEMENT BEFORE MAKING USE OF THIS DOCUMENT.

This document is published by Truline Systems. The information contained within this publication is for general information purposes only. The publication has not been prepared to meet the individual requirements of any particular construction project and it is your responsibility to ensure that the construction materials, techniques and processes are suitable for that particular use.

The information contained within this publication is not intended to amount to, nor should it be relied upon as, formal advice or guidance (including from any qualified professional).

The information provided is only to be used and acted on by, or under the supervision of suitably qualified individuals and is correct at the time of going to press. However Truline Systems reserves the right to amend specifications without prior notification in accordance with our policy of continuous development.

The information in this publication is not to be used as a substitute for obtaining suitable independent, professional, qualified and/or specialist advice. If you are not a suitably qualified professional, you must obtain your own independent, specialist advice from a relevant qualified professional for any construction project.

Truline Systems shall not be liable for any loss of profit, revenue, business, contract, opportunity, goodwill, reputation, or any indirect, special or consequential loss arising out of, or in connection with, this publication.

If you have any queries, please contact [technical@trulinesystems.co.uk](mailto:technical@trulinesystems.co.uk)